

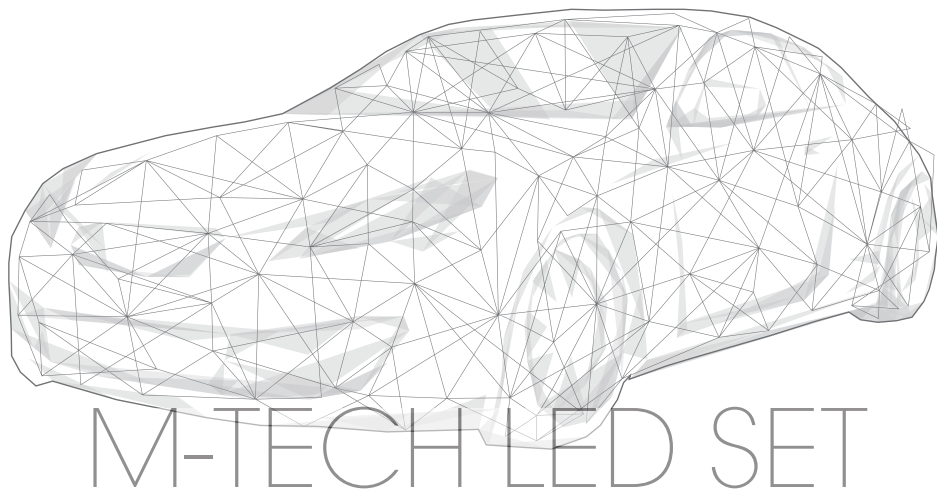

TECH



M-TECH LED SET



Instrukcja montażu.



Mounting instruction.



Montageanleitung M-TECH Led Set.



Guida all'installazione.



Manual de instalación.



Notice de montage.



Instrukce k instalaci.

Osram
LEDS
INSIDE



1 BEFORE INSTALLATION

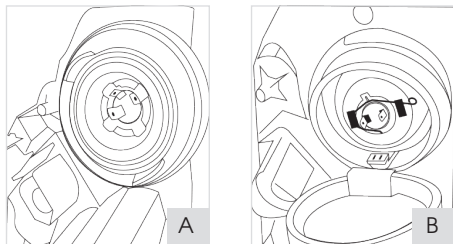

Confirm whether overall size of the LED bulb can fit in the lamp housing:

- a) Original bulb installed outside the dust cover;
- b) Original bulb installed inside the plastic lamp housing.

2 IMPORTANT INFORMATION

Please read the installation manual carefully before installing the LED kit.

Attention:

- Before installation, please make sure the LED bulbs are clean and undamaged.
- Even though the control box is waterproof and heat-resistant, installation on the hot engine parts is not advised.
- Make sure the LED bulbs are appropriate for your car model.
- Make sure your car battery is disconnected during the installation process.

Warning:

- Make sure the LED chips are clean before installation.
- Do not stare directly at the LED bulbs when they are switched on.
- Do not touch the LED bulbs when they are switched on.

Other :

- Check if the installed LED bulbs work properly and there is no warning sign appearing on your dashboard.
- Make sure the dust cover is installed properly.
- Make sure that none of the newly installed wires interfere with any other wires.
- Do not overbend the wires.

This LED kit can not be legally used on public EU roads. Using it on public EU roads may result in driver license and/or insurance loss. OFF ROAD ONLY.

3 CONTENTS

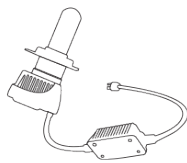

Pair of led bulbs x2



User manual x1

HIGH/LOW BEAM KIT



Pair of led bulbs x2



User manual x1

SINGLE BEAM KIT (H7 excluded)

4 HIGH/LOW BEAM KIT (H4/H13/9004/9007)

4.1 Outside heat sink installation

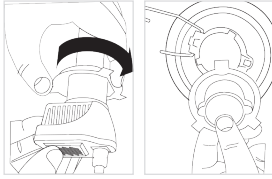

1. Twist the bracket anticlockwise to take off the LED bulb base and fit the bulb into the socket.



2. Mount the dust cover and put back the LED bulb base. Twist it clockwise and make sure the LED bulb is fitted properly.

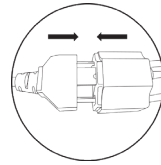

3. Connect to the original plug. Use a zip-tie or double-sided tape to mount the control box.

4.2 Inside lamp housing installation

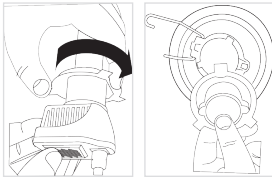

1. Twist the bracket anticlockwise to take off the LED bulb base and fit the bulb into the socket.



2. Put back the LED bulb base. Twist it clockwise and make sure the LED bulb is fitted properly. Connect to the original plug.

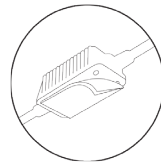
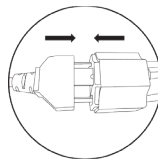

3. Use a proper double-sided tape to mount the control box. Put the cover back on.

5 SINGLE BEAM (H7/H11/9005/9006/5202)

5.1 Outside heat sink installation

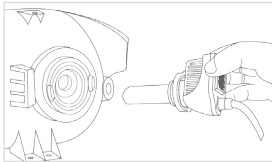

1. Replace the original bulb with the M-TECH LED bulb.

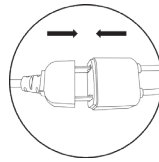

2. Connect to the original plug. Use a zip-tie or double-sided tape to mount the control box.

5.2 Inside heat sink installation

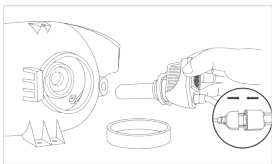

1. Replace the original bulb with the M-TECH LED bulb.



2. Connect to the original plug. Use a proper double-sided tape to install the control box. Put the dust cover back on.

6 Single beam H3/H1

6.1 Inside heat sink installation

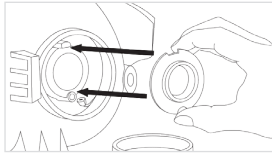

1. Remove the dust cover and the original bulb. Remove the LED bulb base and put it in place of the original bulb. Use a screwdriver to install the LED bulb base. In case of the H1 LED bulb – put it into the hole and secure it with a circlip.

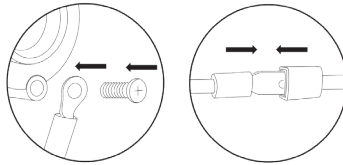

2. **H3 bulb:** Attach the cathode wire ring to the original screw hole.

H1 bulb: Connect the cathode wire to any metal part of the vehicle, and then connect the original anode pins.

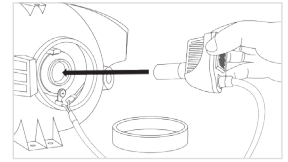

3. Insert the original H3 LED bulb into the hole. Turn it clockwise and make sure the LED bulb is fitted properly.



4. Use a proper double-sided tape to install the control box. Put the dust cover back on.

7 TROUBLESHOOTING

If the LED kit does not work properly, please follow the steps below:

- Check if the plugs are connected the right way.
- Check if your car battery is charged.

8 ENVIRONMENT

Materials suited for recycling have been used in the manufacturing process of this LED kit.

The marks on the package mean that the product meets all European requirements of 2002/96/EC.

Please, do not dispose this product with other waste. Apply to the garbage classification law in your country.



TECH

M-TECH Poland Sp. z o.o.

 ul. Redena 10, 41-807 Zabrze, POLAND

 +48 32 428 42 80

 +48 32 428 42 99

 info@M-TECH.pl

 www.M-TECH.pl